

est 1979

Jeremy
Leaf & Co.



Stokes Court, Diploma Avenue, London, N2 8NX

£175,000

- Communal Gardens
- Communal Lounge
- One Double Bedroom
- Chain Free
- 24 Hour Warden Assisted
- Lease Approximately 60 Years
- Service Charge Approximately £2,600 p.a.
- Residents Parking

98 High Road, London, N2 9EB
020 8444 5222

eastfinchley@jeremyleaf.co.uk
<https://www.jeremyleaf.co.uk/>

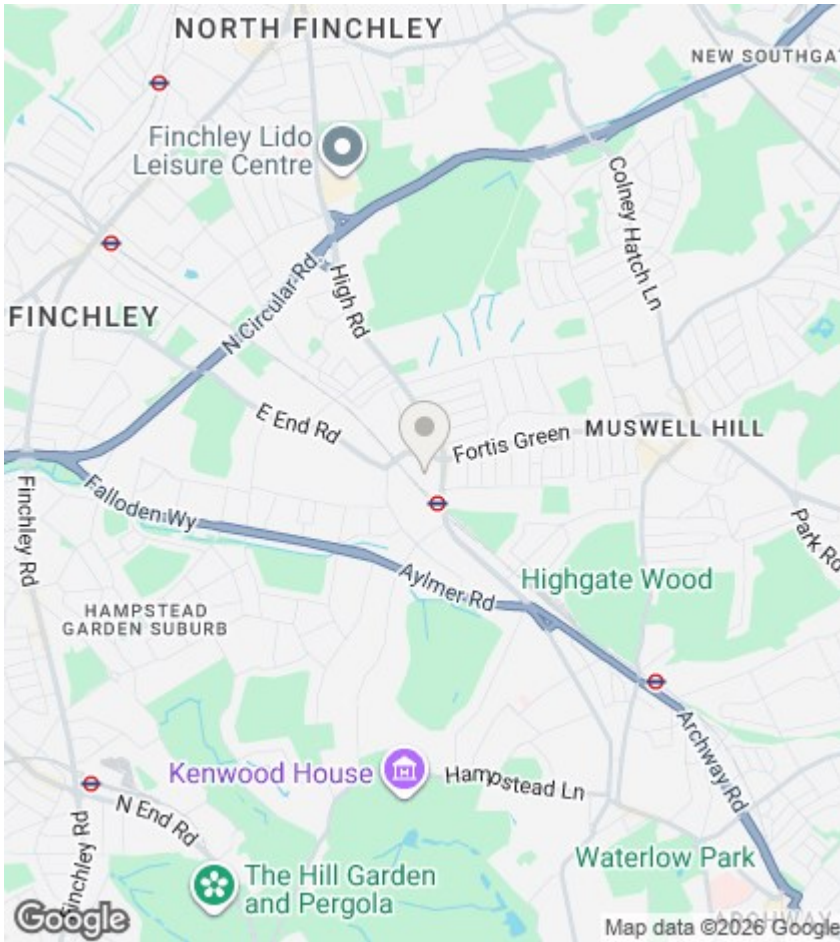

Directions

Viewings

Viewings by arrangement only. Call 020 8444 5222 to make an appointment.

Council Tax Band:

C

EPC Rating:

D

Energy Efficiency Rating		Current	Potential
Very energy efficient - lower running costs			
(92 plus) A			
(81-91) B			
(69-80) C			79
(55-68) D		56	
(39-54) E			
(21-38) F			
(1-20) G			
Not energy efficient - higher running costs			
England & Wales		EU Directive 2002/91/EC	

Approx Gross Internal Area
42 sq m / 455 sq ft

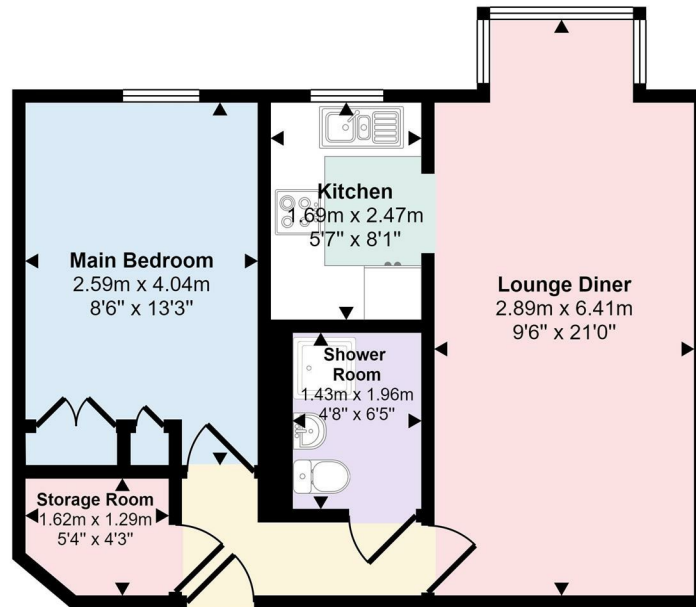

Floorplan

This floorplan is only for illustrative purposes and is not to scale. Measurements of rooms, doors, windows, and any items are approximate and no responsibility is taken for any error, omission or mis-statement. Icons of items such as bathroom suites are representations only and may not look like the real items. Made with Made Snappy 360.